

INFORMATION FROM THE INVESTIGATING OFFICERS REPORT OF MOTOR VEHICLE ACCIDENT

Case Number: **18-0718**
 Date of Acc: **02/02/18**
 Time of Acc: **15:37** Hrs.
 Name of Agency: **IDA COUNTY SHERIFF'S OFFICE**
 Officer: **MCMILLEN ROB**
 Badge #: **47-7**
 Report Date: **02/02/2018**
 Officer Notified: **15:37** Hrs.
 Officer Arrived: **16:54** Hrs.
 Scene Investigated: **YES**

Report to All Drivers:
 Legal Intervention: **NO**
 Private Property: **YES**
 County: **IDA - 47**
 Acc Loc City:
 Acc Dir From City:
 Closest City:
 Miles From City:
 Road, Street, HWay:
 Definable Location:
 Milepost Number:

At Intersection with:
 Div HWay Trvl Dir:
 Distance 1:
 Direction 1:
 Distance 2:
 Direction 2:
 X-Coordinate: **00286238**
 Y-Coordinate: **04689191**
 Location Literal: **2609 DODGE**
 Description:

Unit 001

Driver Name - Last: REHSE	Bus Use:	Transported to: N/A
First: BRENDA		
Middle: KAY	Dvr Distractions: 02 - NOT DISTRACTED	Transported by: N/A
City: BATTLE CREEK		
State: IA	Traffic Controls: 01 - NO CONTROLS PRESENT	Special Veh Func: 01 - NO SPECIAL FUNCTION
Zip: 51006-0000		
Suffix:	Point of Init Impact: 01 - FRONT PASSENGER SIDE CORNER	Emergency Status: 01 - NOT APPLICABLE
Gender: Female	Most Damaged Area: 02 - FRONT PASSENGER SIDE	Cont. Circum., Dvr: 98 - OTHER (EXPLAIN IN NARRATIVE)
Age: 47	Undrrid/Ovrid: 1 - NONE	
CDL: NO	Rpr/Rplc Cost: \$2,500.00	
License State: IA	Ext of Damage: 9 - UNKNOWN	
License Class: C	First Event: 98 - OTHER (EXPLAIN IN NARRATIVE)	Carrier Name:
License Endorsmnt:		Carrier Address:
License Restrictions:	Second Event:	Carrier City:
Speed Limit:	Third Event:	Carrier State:
Seating Position: 01 - 1ST ROW: LEFT SIDE/MOTORCYCLE DRIVER	Fourth Event:	Carrier Zip:
Driver Condition: 01 - APPARENTLY NORMAL		Cargo Body Type: 01 - NOT APPLICABLE
Alcohol Test Given: NO	Most Harmful Event: 98 - OTHER (EXPLAIN IN NARRATIVE)	Number of Axles:
Drug Test Given: 1 - NONE	Abg Switch Stat:	HazMat Involvement:
Total Occupants: 1	Abg Deploy: 03 - NOT DEPLOYED	HazMat Placard:
Vehicle Year: 2002	Trapped: 1 - NOT TRAPPED/APPLICABLE	Placard #:
Vehicle Make: CHEVROLET - CHEV	Ejection: 2 - NOT EJECTED	HazMat Released?:
Vehicle Model: IMP	Ejection Path: 01 - NOT EJECTED/NOT APPLICABLE	Converter Dolly:
Vehicle Style: 4D	Occpnt Protect: 03 - SHOULDER AND LAP BELT USED	GVWR:
Vehicle Color: RED - RED		Cit Chrg Code 1:
Vehicle Config: 01 - PASSENGER CAR	Source of Trans: 01 - NOT TRANSPORTED	Citation Charge 1:
Vehicle Defect: 15 - POWER TRAIN	Died at Scene: 01 - NOT APPLICABLE	Cit Chrg Code 2:
Vehicle Action: 01 - MOVEMENT ESSENTIALLY STRAIGHT		Citation Charge 2:
Tow: 1 - DRIVEN AWAY		Citation Charge 3:
Tow #:		Citation Charge 4:
Initial Trvl Dir: 04 - WEST		
Vision Obscured: 01 - NOT OBSCURED		

Unit 002

Driver Name - Last:	Bus Use:	Transported to:
First:		
Middle:	Drvr Distractions: 01 - NOT APPLICABLE/NO DRIVER	Transported by:
City:		
State:	Traffic Controls: 01 - NO CONTROLS PRESENT	Special Veh Func:
Zip:		
Suffix:	Point of Init Impact: 11 - FRONT DRIVER SIDE CORNER	Emergency Status:
Gender:		
Age:	Most Damaged Area: 11 - FRONT DRIVER SIDE CORNER	Cont. Circum., Drvr: 88 - NO IMPROPER ACTION
CDL:	Undrrid/Ovrid: 1 - NONE	
License State:	Rpr/Rplc Cost: \$1,000.00	
License Class:	Ext of Damage: 3 - FUNCTIONAL DAMAGE	
License Endorsmnt:	First Event: 35 - PARKED MOTOR VEHICLE	
License Restrictions:		Carrier Name:
Speed Limit:		Carrier Address:
Seating Position:		Carrier City:
	Second Event:	Carrier State:
Driver Condition:		Carrier Zip:
Alcohol Test Given:	Third Event:	Cargo Body Type: 01 - NOT APPLICABLE
Drug Test Given:		
Total Occupants: 0	Fourth Event:	Number of Axles:
Vehicle Year: 2012		HazMat Involvement:
Vehicle Make: NISSAN - NISS		HazMat Placard:
Vehicle Model: MUR		Placard #:
Vehicle Style: SW	Most Harmful Event: 35 - PARKED MOTOR VEHICLE	HazMat Released?:
Vehicle Color: WHITE - WHI		Converter Dolly:
Vehicle Config: 03 - SPORT UTILITY VEHICLE	Abg Switch Stat:	GVWR:
	Abg Deploy:	Cit Chrg Code 1:
Vehicle Defect: 01 - NONE		Citation Charge 1:
	Trapped:	
Vehicle Action: 12 - LEGALLY PARKED	Ejection:	
	Ejection Path:	Cit Chrg Code 2:
Tow: 1 - DRIVEN AWAY		Citation Charge 2:
	Occpnt Protect:	
Tow #:		
Initial Trvl Dir: 99 - UNKNOWN		Citation Charge 3:
Vision Obscured:		
	Source of Trans:	
	Died at Scene:	Citation Charge 4:

Property Damage 001

Object Damaged: GARAGE DOOR	Company Owner Name:
Estimate of Damage: \$1,500.00	City: BATTLE CREEK
Owner's Name - Last: REHSE	State: IA
First: BRENDA	Zip Code: 51006-8600
Middle: KAY	
Suffix:	

Accident Environment

First Harmful Event Loc: 06 - OUTSIDE TRAFFICWAY	Roadway Characteristics
Manner of Crash/Collision: 02 - HEAD-ON (FRONT TO FRONT)	Environment: 01 - NONE APPARENT
Light Conditions: 1 - DAYLIGHT	Roadway: 01 - NONE APPARENT
Weather Conditions: 01 - CLEAR	
	Type of Road Junc/Feat: 01 - NON-JUNCTION/NO SPECIAL FEATURE
Surface Conditions: 01 - DRY	
	FRA No.:
Workzone Related: NO	Horizontal Alignment:
Activity:	Vertical Alignment:
Location:	
Type:	First Harmful Evt of Crash: 98 - OTHER (EXPLAIN IN NARRATIVE)
Workers Present:	

Narrative

The driver of Unit 1 had placed car into Park and the engine revved up and the vehicle drove through the Garage. The Vehicle busted through the over head door and struck vehicle in the Garage. No one was injured in the accident.

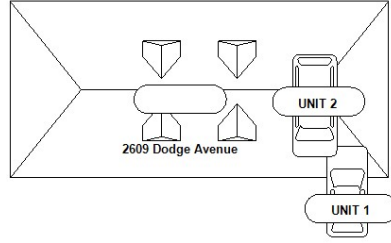

NOT TO SCALE

